

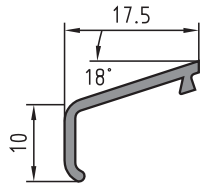

## 214 308 FA 17.5



Glasfalzwange 15/16 mm  
Verglasung ohne Vorlegeband  
Glass rebate frame side 15/16 mm  
Glazing without glazing tape

## 214 330 FA 21

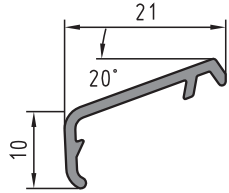

Glasfalzwange 15/16 mm  
Verglasung mit Vorlegeband  
Glass rebate frame side 15/16 mm  
Glazing with glazing tape  
Glasfalzwange 18 mm  
Verglasung ohne Vorlegeband  
Glass rebate frame side 18 mm  
Glazing without glazing tape

## 214 317 FA 21.5

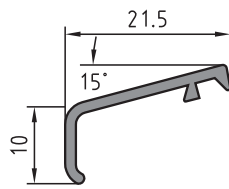

Glasfalzwange 18 mm  
Verglasung mit Vorlegeband  
Glass rebate frame side 18 mm  
Glazing with glazing tape  
Glasfalzwange 20 mm  
Verglasung ohne Vorlegeband  
Glass rebate frame side 20 mm  
Glazing without glazing tape

## 214 306 FA 23

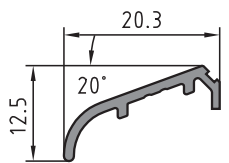

Glasfalzwange 15/16 mm  
Verglasung mit Vorlegeband  
Glass rebate frame side 15/16 mm  
Glazing with glazing tape

## 214 301 FA 24.41

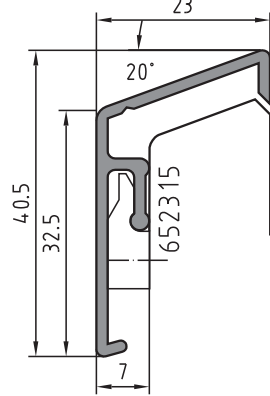

Glasfalzwange 15/16 mm  
Verglasung mit Vorlegeband  
Glass rebate frame side 15/16 mm  
Glazing with glazing tape  
Glasfalzwange 18/20 mm  
Verglasung ohne Vorlegeband  
Glass rebate frame side 18/20 mm  
Glazing without glazing tape

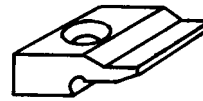

**652 315**  
**Klipshalter**  
VE 100 Stück  
PU 100 pieces



**214 505**  
**Klipshalter**  
VE 100 Stück  
PU 100 pieces

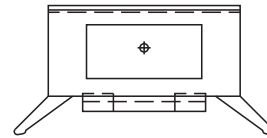

**110 536**  
**Klipshalter**  
VE 100 Stück  
PU 100 pieces

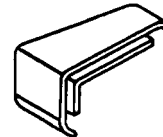

**FA 21 Endkappe**  
VE 100 Stück  
PU 100 pieces



**FA 23 Endkappe**  
VE 100 Stück  
PU 100 pieces

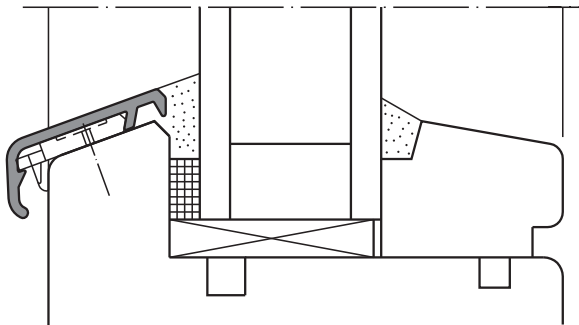

**Einbaubeispiel FA 21**  
**Installation example**



**FA 24.41 Endkappe**  
VE 100 Stück  
PU 100 pieces

Profil Profile	Typ Type	lagerhaltige Oberflächen available surfaces on stock					VE PU	Halter Holder	Endkappen 20° Endcaps 20°		Endkappen 15° Endcaps 15°	
		AU	BC 0	BC 2,5	BC 4	RAL 9016			links / left	rechts / right	links / left	rechts / right
FA 17.5	214 308	X					144 m	214 505	210 966	210 967	210 324	210 325
FA 21	214 330	X	X	X	X	X	144 m	110 536	210 966	210 967	210 324	210 325
FA 21.5	214 317	X	X	X	X	X	144 m	214 505	210 966	210 967	210 324	210 325
FA 23	214 306	X	X	X	X	X	144 m	-	214 309	214 310	214 314	214 315
FA 24.41	214 301	X					144 m	652 315	-	-	214 332*	214 333*

\*Endkappen/Endcaps 90°

Bitte beachten Sie unsere technischen Hinweise für die Konstruktion und Herstellung von Holzfenstern auf den Seiten 1-01 bis 2-02 dieser Broschüre.  
Please follow our technical instructions for construction and manufacturing of wooden windows on page E 1-01 to E 2-02 in this brochure.